



ABOVE-GROUND
AUTOMATIC SLATTED COVER

moon[®]



**CUSTOMISATION
INNOVATION
SAFETY**

ABOVE-GROUND
AUTOMATIC SLATTED COVER

mon®



SPECIFICATIONS

For pools from 2.5 x 3 m up to 5 x 11 m + Ø 3 m step unit. Available in electric or solar versions.



GLACIER WHITE

CHAMPAGNE GREY

Colours of central disk
(electric version)



- 1 Thermoplastic and composite casing tinted metallic champagne grey, glacier white, or other colours on request.
- 2 Central colour disk available in 7 standard colours or other colours on request.
- 3 Electric 12 Vcc tubular motor. The motor can be uncoupled and removed.
Optional torque limiter: used to stop the opening of the cover if an abnormal strain is detected on it.
- 4 Solar version: single glass solar panel with photovoltaic cells.
- 5 Cover composed of opaque PVC or polycarbonate solar slats fitted with locking kits.
Slats available in several colours for perfect matching with your environment.
- 6 Remotely controlled by Wi-Key, the wireless remote control box, or key switch button.



Pushlock locking kit system

Flexible stainless steel weight: in case you forgot to unlock the Pushlock when opening the cover, the material damage is reduced.

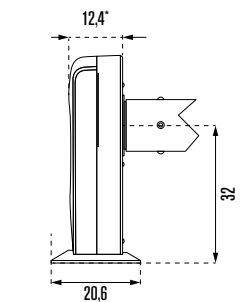

Side view

(*+1 cm for aniseed green disk)

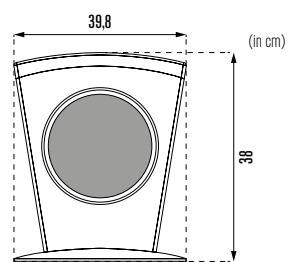

Front view



THANKS TO ITS MODERN AND CUSTOMISABLE DESIGN, THE ABOVE-GROUND AUTOMATIC SLATTED COVER Moon® CAN BE PERFECTLY INTEGRATED INTO THE STYLE OF EACH PROJECT. SOLAR OR ELECTRIC, IT ADAPTS TO BOTH NEW BUILD OR REFURBISHED POOLS.

CUSTOMISATION

Available in standard Glacier white or Champagne grey, the above-ground automatic slatted cover Moon® is also available in a wide variety of optional colours.

Its interchangeable colour disks make it possible to add a touch of colour around the pool!

The solar version of Moon® requires no works and is perfectly suited to refurbishment projects.

SAFETY

As all DEL covers, Moon® is certified by the French National Test Laboratory and is compliant with standard NF P 90-308 relative to the french pool safety Act. Composed of opaque PVC or polycarbonate solar slats and locking kits, it makes it possible to completely close the pool preventing access by children under 5.

DESIGN

Born from the collaboration between a designer and our research and development laboratory, Moon® is a unique above-ground automatic slatted cover concept in which the design prefigures leading edge technology. The customisation of the terminal makes its perfect integration into your pool environment possible.



THE WIRELESS REMOTE CONTROL BOX



- Pool opening and closure information is sent using digital wireless communications.
- No connections or cable passages.
- An aesthetic and watertight control box for indoor or outdoor installations.
- Use secured by a password and compliant with the NF P 90-308 safety standard.





SLATS



Polycarbonate solar slats

Compliant with the NF P 90-308 standard (DEL exclusivity)
Available in 6 colours: crystal black, crystal blue, crystal green, crystal, crystal brown and silver black*

*Norm in process.

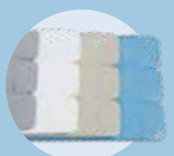

Opaque PVC slats

Compliant with the NF P 90-308 standard
Available in 4 colours: grey, white, beige, blue



IVERNEA / IVERNEA PLUS

Remember to order your **winter shield Ivernea** or your **4 seasons protective covering Ivernea Plus** to protect the cover from UVs and dirt.

MAXIMUM SAFETY

An essential addition to DEL covers, the safety kits ensure the complete closure of your pool. A wide range of colours makes it possible to match the kits to your coating colour.

Ask your pool professional for advice.



The purpose of DEL safety covers is not to replace the vigilance of parents and/or responsible adults which remains the essential factor for the safety of young children. DEL automatic slatted covers are safety covers designed to prevent children under 5 years old from accessing the pool. A child can drown under in 3 minutes, no type of protective measure can replace the monitoring and vigilance of a responsible adult.

Please read carefully and keep in a safe place.

Moon[®] is a pool safety cover designed to prevent children under 5 years old from accessing the pool. This product complies with the NF P 90-308 standard. It is not a substitute for common sense or personal responsibility. The purpose of this cover is not to replace the vigilance of parents and/or responsible adults which remains the essential factor for the safety of young children. A child can drown in under 3 minutes, no type of protective measure can replace the monitoring and vigilance of a responsible adult. **Guarantee:** 3 years for the motor and slats, 2 years for roller in compliance with our general sales terms and conditions. **Order forms:** for the cover to be correctly fitted to the pool it is essential to supply a drawing of the pool with measurements taken every metre. In compliance with standard NF P 90-308, the gap between the inside of the pool and the edge of the cover must be less than 70 mm. **Manoeuvre time:** 3 minutes for automatic opening or closure plus 30 seconds to lock or unlock the safety locking system. Moon can be opened and closed by a single person. **Use:** in all seasons. For the cover to operate correctly maintain a constant water level corresponding to normal pool filtering. It is essential to fit a water level regulator. The water level must be compliant with the instructions. **Use limitations:** the installation of an automatic DEL cover on overflow pools and/or pools with steps on the length side (removable steps on the side) is not compliant with standard NFP 90-308. In this case please use other compliant equipment. Unless otherwise specified by the manufacturer, immersion alarms are not compatible with DEL automatic slatted covers. **Wintering:** close the pool for winter depending on the geographic location. Without lowering the water level, close the cover in the safety position and eventually install a wintering net to protect the cover. If the water level is dropped to put the parts to insert above the water line, roll the cover and secure the pool using a safety wintering cover. **Packing list:** for 5 x 10 m pool. Slats: 5 packs of 5.10 x 0.25 x 0.20 m. Tube: 1 pack 5.46 x Ø 0.20 m. Supports: 1 pallet of 0.80 x 0.60 x 0.50 m. Weight: 282 kg.

Manufacturer: DEL La Basse Croix Rouge 35530 BRECE - France / export@fija-group.com / www.del-piscine.fr.

For more information about these products ask your pool professional for advice.

Distributor's stamp